

# Drainage instructions

## PleurX<sup>®</sup> catheter system

These instructions are to be used only as a reference. Read the Instructions for Use that come with the drainage kits and watch the *drainage video* for more detailed instructions.

### Getting started

Get all drainage supplies ready and thoroughly wash your hands.



**1** Open all packaging. Unfold blue wrapping. Place bottle near wrapping and lay access tip on blue wrapping.

**2** Tear open alcohol pads. Lay open pouches on blue wrapping a short distance from sterile items.



**3** Pick up each glove by the wrist and put both of them on.

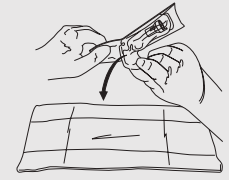

**4** Open pouch containing valve cap and let it fall onto sterile blue wrapping.

### Connecting the drainage bottle

Be sure to keep the end of the catheter and access tip clean.

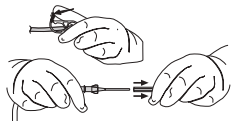

**5** Squeeze clamp on drainage line completely closed and remove cover from access tip.

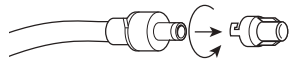

**6** Take valve cap off catheter.

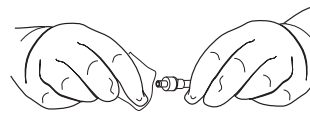

**7** Clean around valve opening with first alcohol pad.

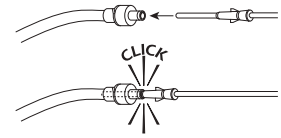

**8** Insert access tip into catheter valve.

### Draining fluid

Do not drain more than 1000mL from your chest or 2000mL from your abdomen at any one time.

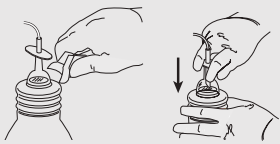

**9** Remove support clip from top of drainage bottle and push down "T" plunger.

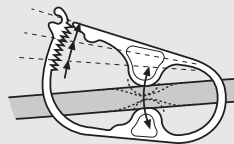

**10** Release clamp on drainage line to begin draining.

**11** Squeeze clamp on drainage line completely closed when finished draining.

### Final steps and disposal

If you have any questions or concerns, contact your doctor or nurse.

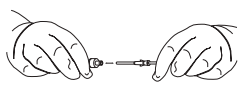

**12** Pull access tip out of valve; set drainage line down.



**13** Clean around valve opening with second alcohol pad.

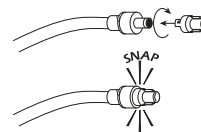

**14** Place new cap on catheter valve and twist it until it snaps into its locked position.



**15** Clean around catheter site with third alcohol pad.



**16** Place foam catheter pad around catheter and wind catheter on top of pad. Cover catheter with gauze pads.



**17** Place self-adhesive dressing over gauze pads and remove plastic covering.

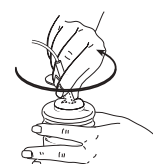

**18** Push down "T" plunger and move plunger in a circular motion to further puncture the foil seal so fluid can be poured out.

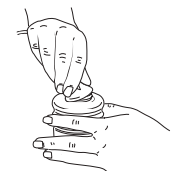

**19** Remove flexible cap and drainage line from bottle.

**20** Empty bottle into toilet. Place bottle in a plastic bag, seal tightly and discard.

© 2009 CareFusion Corporation or one of its subsidiaries. All rights reserved. PleurX is a registered trademark of CareFusion Corporation or one of its subsidiaries. IS1192 (1209/20000)

CareFusion  
Waukegan, IL

[carefusion.com](http://carefusion.com)



CareFusion