

Application Guide

- 1 Cleanse the wound/skin in accordance with local procedures. The peri-wound skin should be clean and dry to assist adhesion.
- 2 Select the appropriate size. For wounds, the dressing pad should overlap the wound by 3/4 inch. **Do not cut dressing to size.**
- 3 Remove one side of the release liner and apply the dressing to the skin or wound.
- 4 To assist adhesion, gently press the adhesive to the skin.
- 5 Smooth the dressing to facilitate good contact between the pad and the skin wound. Remove the remaining release liner.
- 6 Check the dressing at regular intervals and change according to the clinical condition of the wound, when saturated or per hospital protocol.

Application of shapes

SQUARE/RECTANGLE

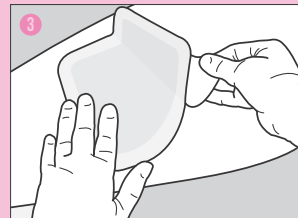
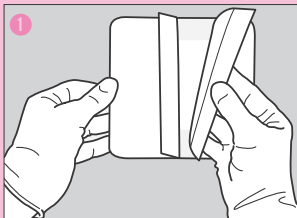

HEEL

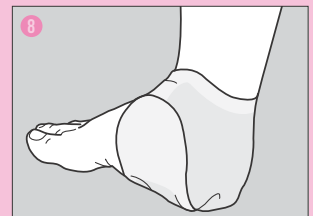
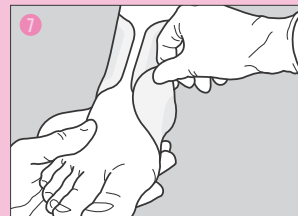
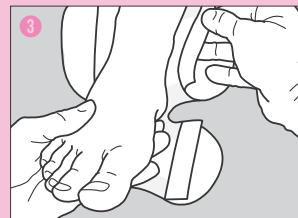
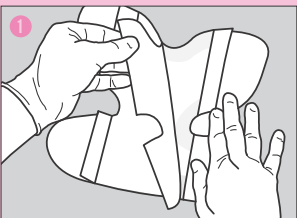

SACRUM

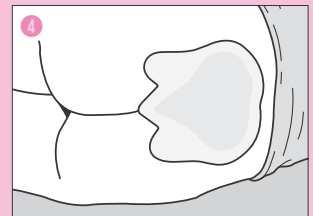
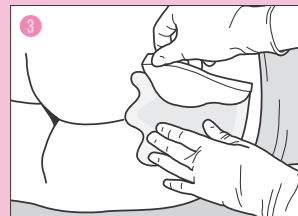
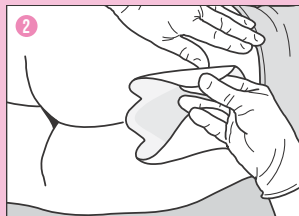
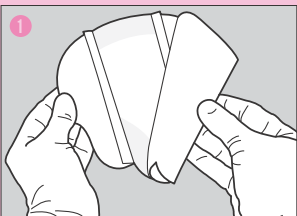



KerraFoam®

Gentle Border

Designed for protection and exuding wounds, secured with a gentle silicone contact layer.

ORDER INFORMATION

Product Code	Size (pad size)	Dressings per box	HCPCS
CWL1010	3 x 3 in (2 x 2 in)	10	A6212
CWL1011	4 x 4 in (3 x 3 in)	10	A6212
CWL1013	5 x 5 in (4 x 4 in)	10	A6212
NEW CWL1132	6 x 6 in (5 x 5 in)	10	A6213
NEW CWL1135	7 x 8 in Oval (6 x 7 in)	10	A6213
CWL1012	4 x 8 in (3 x 7 in)	10	A6212
NEW CWL1133	4 x 10 in (3 x 9 in)	10	A6213
NEW CWL1134	4 x 12 in (3 x 11 in)	5	A6213
CWL1023	6.7 x 6.9 in Small Sacrum	5	A6212
CWL1040	9 x 10 in Large Sacrum	5	A6213
CWL1024	9.8 x 9 in Heel	5	A6213

To purchase product please contact your medical supply distributor or call 855-522-2211



Crawford Healthcare Inc. | 2005 South Easton Rd. | Suite 203 | Doylestown, PA 18901
 Tel 855-522-2211 | Email us.info@crawfordhealthcare.com
<http://us.crawfordhealthcare.com>

KerraFoam® is a registered trademark of Crawford Woundcare Ltd | © Copyright Crawford Healthcare Ltd, 2016.